



Panuhat Karmaudyog Welfare Society

(Implementing Agency for Purba Bardhaman Coir Cluster)

Panuhat, Boliyapara, Katwa, Purba Bardhaman – 713502

Mobile:+91- 62942 55814 Email: panuhatkwellfaresociety@gmail.com



Short Tender Notice

Ref: SFURTI/PKWS/SRT-TEN/2021/01

Date: 22.02.2021

Sealed tenders are invited from **Reputed civil engineers/ contractors** / Having minimum three years of experiences in building construction/ Credentials of a similar nature of work of the minimum value of 40% of the estimated amount put to tender during 5 (five) years prior to the date of issue of this tender notice for establishment of Common Facilities Centre **M/s. Purba Bardhaman Coir Cluster at Birbegun, Agradwip, Katwa, Purba Bardhaman, W.B.**

Description of work	Package No.	Site location	Approximate value of work	EMD (in Rs.)	Period of execution
Construction Of Processing Centre, Office And Training Centre including Well and Pump Set for the Common Facility Center of Purba Bardhaman Coir Cluster	Package I	Vill. Birbegun, Sahapur, Post:-Islampur, Agradwip, P.S.-Katwa, Dist:-Purba Bardhaman, Pin;713502 (W.B.)	Civil Works- Rs.77 Lakhs & Rs.1.5 lakhs for Well & Pump Set	1,57,000/-	120 days

Tender document is available in the websites www.coirboard.gov.in and to enable the tenderers download the tender document up to 05.00 PM on 05.03.2021.

- Date of commencement of issue of tender 22.02.2021
- Date & Time of Pre-Bid Meeting 02.03.2021, 11.00 AM
- **Last date for submission of Tenders** 05.03,2021, 05.00 PM
- Date of opening of bid 06.03.2021, 10.00 AM

Place Tender Submission: Coir Board Sub Regional Office New Secretariat Building C Block, Ground Floor, Kiran Sankar Roy Road, Kolkata – 700001

Place of Opening of Technical bid and Price bid: Coir Board Sub Regional Office New Secretariat Building C Block, Ground Floor, Kiran Sankar Roy Road, Kolkata – 700001.

Secretary
M/s.Panuhat Karmaudyog Welfare Society

M/s Panuhat Karmaudyog Welfare Society
(Implementing Agency - Purba Bardhaman Coir Cluster,
Purba Bardhaman District)

Office: Panuhat, Katwa, Purba Bardhaman, Pin 713502
Mobile: (+91) 6294255814, **Email:** panuhatkwelfaresociety@gmail.com

TENDER REFERENCE No. SFURTI/PKWS/SRT -TEN/2021/01

TENDER DOCUMENTS

**CONSTRUCTION OF PROCESSING CENTRE, OFFICE AND TRAINING
CENTRE FOR THE COMMON FACILITY CENTER OF PURBA
BARDHAMAN COIR CLUSTER**

Date & Time of Release of Tender	22.02.2021
Date & Time of Pre-Bid Meeting	02.03.2021, 11.00 AM
Last Date & Time for Submission of Bid	05.03,2021, 05.00 PM
Date & Time of Opening of Bid	06.03.2021, 10.00 AM

Technical Agency (SFURTI)

F.M.C.-Foundation of MSME Clusters

E-mail: info@fmc.org,

Website: www.fmc.org.in

CONTENTS

Clause	Topic	Page No.
1.	PREAMBLE	1
2.	SCOPE OF WORK.....	2
3.	QUALIFICATION CRITERIA	2
4.	LANGUAGE OF THE TENDER.....	3
5.	PURCHASE OF TENDER DOCUMENT	3
6.	PREBID MEETING	3
7.	CLARIFICATION ON THE TENDER DOCUMENT	4
8.	AMENDMENT OF TENDER DOCUMENT	4
9.	AUTHORISATION OF THE TENDERER	4
10.	PRE-VISIT OF SITE	4
11.	SPECIFIC INSTRUCTIONS TO BIDDERS/CONTRACTORS.....	4
12.	SUBMISSION OF TENDER IN TWO COVER SYSTEM.....	5
13.	EARNEST MONEY DEPOSIT	5
14.	VALIDITY.....	6
15.	OPENING AND EVALUATION OF THE TENDER.....	6
16.	PRICE OFFER.....	7
17.	EVALUATION OF THE PRICE	7
18.	AWARD OF CONTRACT.....	7
19.	SECURITY DEPOSIT.....	7
20.	AGREEMENT	8
21.	ISSUE OF WORK ORDER.....	8
22.	DEFECT IDENTIFICATION & RECTIFICATION	8
23.	EMPLOYMENT OF TECHNICAL ASSISTANTS	8
24.	PAYMENT TERMS	8
25.	PENALTY	9
26.	TERMINATION OF CONTRACT	9
27.	GENERAL CONDITIONS.....	9
28.	ARBITRATION.....	10
29.	JURISDICTION OF THE COURT	10

ANNEXURES

I.	BUILDING DRAWING & BOQ	12
II.	PART-I (COVERING LETTER)	43
III.	DETAILS OF THE TENDERER.....	45
IV.	ANNUAL TURNOVER STATEMENT.....	46
V.	LIST OF WORKS EXECUTED IN LAST 3 YEARS	47
VI.	DECLARATION OF NOT HAVING BLACKLISTED.....	48
VII.	DECLARATION FOR NOT HAVING TAMPERED THE TENDER DOCUMENT ..	49
VIII.	PART-II (COVERING LETTER).....	50
IX.	PRICE BID.....	51
X.	CHECKLIST OF DOCUMENTS	52

**SHORT TENDER FOR THE CONSTRUCTION OF INDUSTRIAL WORK SHED
BUILDINGS AND AMENITIES FOR PURBA BARDHAMAN COIR CLUSTER**

1. PREAMBLE

Ministry of MSME, Government of India has formulated “**Scheme of Fund for Regeneration of Traditional Industries (SFURTI)**”, with a view for making the traditional industries and artisans more productive and competitive and facilitating their sustainable growth. The scheme stipulates **Foundation for MSME Clusters** as one of the Nodal Agencies for these clusters.

The scheme specifies the following institutional arrangement at the operational level:

- a Special Purpose Vehicle (SPV) be formed to develop and manage the cluster
- an Implementing Agency (IA) is appointed to undertake scheme implementation
- a Technical Agency (TA) is designated to assist and guide the scheme implementation

PURBA BARDHAMAN COIR CLUSTER is approved under the scheme. **M/s. PANUHAT RURAL WELFARE SOCIETY, , Panuhat, Boliyapara, Katwa, Purba Bardhaman 713502** at is the Special Purpose Vehicle (SPV) of the Cluster. **Panuhat Karmaudyog Welfare Society** is the Implementing agency of the cluster and **M/s. Foundation for MSME** the designated Technical agency for the cluster.

The scheme envisages establishment of upgraded production infrastructure, as the Common Facility Center (CFC), for the manufacturing of coir products and stipulates the building construction and machinery procurement for the establishment of CFC should adhere the General Financial Rules (GFR) of Government of India. Accordingly, the tender procedures are being undertaken for the construction of CFC building works and procurement of machineries.

Panuhat Rural Welfare Society , the Special Purpose Vehicle (SPV) of Purba Bardhaman Coir Cluster having the administrative office at **Panuhat, Boliyapara, Katwa, Purba Bardhaman 713502** is establishing a Common Facility Centre (CFC) in (CFC : **Vill. Birbegun, Sahapur, Post:-Islampur, Agradwip, P.S.-Katwa, Dist:-Purba Bardhaman,Pin;713502 (W.B.)**), with the financial assistance from Government of India under SFURTI. [(A)**Plot 1203 - Khatian No. – 1482, 1485, 1486, 1488, 1489, 1494 (B) Plot 1204 - Khatian No. – 1484, 1490, 1495, 1496, 1497 (C) Plot 1205 - Khatian No. – 1487, 1507**] with the financial assistance from Government of India under SFURTI.

In this context, on behalf of SPV, **Panuhat Karmaudyog Welfare Society**, the Implementing Agency (IA) of Purba Bardhaman Coir Cluster having administrative office at **Panuhat, Katwa, Purba Bardhaman 713502**, Sealed tenders are invited from **licensed Reputed civil engineers/contractors** /(having minimum three years of experiences in building construction)/ Credentials of a similar nature of work of the minimum value of 40% of the estimated amount put to tender during 5 (five) years prior to the date of issue of this tender notice for establishment of Common Facilities Centre at Vill. Birbegun, Sahapur, Post:-Islampur, Agradwip, P.S.-Katwa, Dist:-Purba Bardhaman, Pin:713502.The Tender notification has been published fixing the date of opening of tender as **06.03.2021, 11.00 AM.**



2. SCOPE OF WORK

- a) The successful tenderer should undertake Construction Of Processing Centre, Office And Training Centre, for the respective packages . Mouza - SAHAPUR, J.L. No. 95 under G.P. – AGRADWIP [(A)Plot 1203 - Khatian No. – 1482, 1485, 1486, 1488, 1489, 1494 (B) Plot 1204 - Khatian No. – 1484, 1490, 1495, 1496, 1497 (C) Plot 1205 - Khatian No. – 1487, 1507] as per the drawings and Estimate/Bill of Quantity (BoQ) given in Annexure-I.
- b) The successful tenderer should complete the construction of industrial work shed buildings and amenities within 120 days from the date of receipt of Work Order. The time line for the cumulative percentage of work to be completed based on the value of work shall be as given below:

Days	Percentage of work to be completed
1 st 30 days	Min. 20% of total contract value
2 nd 30 days	Min. 20% of total contract value
3 rd 30 days	Min. 40% of total contract value
4 th 30 days	100% of total contract value

3. QUALIFICATION CRITERIA

Clause	Qualification Criteria	Supporting Document
3(a)	The tenderer should be a registered legal entity.	(i) In case of Private / Public Limited Companies, <ul style="list-style-type: none"> • Copy of Incorporation Certificate issued by the Registrar of Companies • Copy of Memorandum and Articles of Association (ii) In case of Partnership Firm, <ul style="list-style-type: none"> • Registered Partnership deed (iii) In case of Proprietorship Concern, <ul style="list-style-type: none"> • Copy of Udyog Aadhaar/ GST Registration Certificate / PAN Card.
3(b)	The tenderer should be an eligible Civil contractor	(i) Credentials of a similar nature of work of the minimum value of 40% of the estimated amount put to tender during 5 (five) years prior to the date of issue of this tender notice. (ii) Valid registration of GST
3(c)	The tenderer should have at least 3 years of experience (as on 31 st July 2020) as Civil contractor.	(i) Work orders issued by clients (ii) Performance certificate issued by clients (iii) List of construction works executed in last 3 years as per Annexure-V
3(d)	The tenderer should have been awarded and successfully completed at least three works of similar nature in the last 3 years (as on 31 st July 2020).	(i) Work orders issued by clients (ii) Performance certificate issued by clients
3(e)	The tenderer should have	(i) The average annual turnover statement duly



	reported a minimum Average Annual Turnover of Rs.100.00 lakhs in the last three consecutive financial years i.e. 2016-17, 2017-18 and 2018-19 (OR) 2017-18, 2018-19 and 2019-20	certified by Chartered Accountant as per Annexure IV (ii) The Annual Report/ certified copies of Balance Sheet, Profit & Loss statement along with schedules for the last 3 consecutive financial years
3(f)	The tenderer should not have been blacklisted for supply of any items or services by any Government departments/agency	The declaration form as per Annexure VI should be enclosed.

4. LANGUAGE OF THE TENDER

The Tender prepared by the tenderer as well as all correspondences and documents relating to the Tender shall be in English language only. If the supporting documents are in a language other than English/Kannada, the notarized translated English version of the documents should also be enclosed.

5. PURCHASE OF TENDER DOCUMENTS

- The tender Schedule shall be downloaded from www.coirboard.gov.in at free of cost. The tenderer should give a declaration for not having tampered the Tender document downloaded from Internet (as per Annexure VII).
- The tender document can be downloaded from **22.02.2021 to 05.03.2021**.

6. PREBID MEETING

There will be a pre-bid meeting on **02.03.2021 at 11.00 am** in the office of the Coir Board Sub Regional Office New Secretariat Building C Block, Ground Floor, Kiran Sankar Roy Road, Kolkata – 700001 during which the prospective tenderers can get clarifications about the tender. The tenderers shall send their queries in writing if any so as to reach IA at least two days prior to the pre-bid meeting date, which would be promptly addressed in the meeting. The tenderers are advised to check www.coirboard.gov.in for up-to-date information like change in date /venue etc., of pre-bid meeting as IA may not be able to identify and communicate with the prospective bidders at this stage. Non attending of pre-bid meeting is not a disqualification. In case of any extended (Covid 19) lockdown period on the date of pre-bid meeting or any other such circumstances, the pre-bid meeting would be conducted by video conferencing on the same date, for which the interested bidders are requested to mail their Email-Id and whatsapp/phone number to the mail Id of the IA (panuhatkelfareociety@gmail.com / +91- 6294255814) before **01.03.2020**.

7. CLARIFICATION ON THE TENDER DOCUMENT

The tenderers may ask for queries in any of the clauses in the tender document before 48 hours of the opening of the tender. Such queries may be sent in writing to “Panuhat Karmaudyog Welfare Society, Panuhat, Katwa, Purba Bardhaman, 713502” or by e-mail to panuhatkelfareociety@gmail.com IA will upload the clarification on www.coirboard.gov.in. It is binding on the part of tenderers to check the above said website for any amendments or clarifications post during the entire tender process.

8. AMENDMENT OF TENDER DOCUMENT

IA whether on its own initiative or as a result of a query, suggestion or comment of an Applicant or a



Respondent, may modify the tender document by issuing an addendum or a corrigendum at any time before the opening of the tender, with the concurrence of the tender committee. Any such addendum or corrigendum will be the same will be binding on all Applicants or Respondents or Tenderers, as the case may be.

9. **AUTHORISATION OF THE TENDERER**

The Tender should be signed on each page by the tenderer or by the person who is duly authorized for the same by the tenderer.

10. **PRE-VISIT OF SITE**

The tenderer, on his/her own responsibility, risk and cost, is advised to visit and examine the site of works [(A)Plot **1203** - Khatian No. – **1482, 1485, 1486, 1488, 1489, 1494** (B) Plot **1204** - Khatian No. – **1484, 1490, 1495, 1496, 1497** (C) Plot **1205** - Khatian No. – **1487, 1507**], at Mouza - **SAHAPUR**, J.L. No. **95** under G.P. – **AGRADWIP PURBA BARDHAMAN, 713502, WEST BENGAL** and its surroundings and obtain all information that may be necessary for preparing the bid and entering into a contract for the work(s) as mentioned in the Annexure (I).

11. **SPECIFIC INSTRUCTIONS TO BIDDERS / CONTRACTORS FOR QUOTING OF RATES**

- (a) The contractors are requested to read the detailed specification and quote the rates clearly in the Price bid. Quoting the rates in the Price bid will only be taken up for comparison and shall be final.
- (b) The tenders invited are based on item wise rates mentioned in the estimate of works/BoQ. Any lumpsum deductions or increase or rebate offered either in the tender or in the covering letter or at any portion of the tender will be ignored and only the rates offered in the Price bid alone will be taken as valid rates and taken up for tender comparison. Rates or Lump sum amounts for items not called for shall not be included in the tender. Any alteration made by tenderer in the contract form, the conditions to Contract, the drawings, specification, or quantities accompanying the same will not be recognized and if any such alterations are made the tender will be void.
- (c) The tenderer / contractor will make his/her/their own arrangements to procure and use ISI Brand Cement and ISI Brand steel required for the work.
- (d) It should be clearly understood that the rate quoted by the tenderer / contractor is inclusive of incidental charges such as conveyance, loading, unloading, stacking at site and testing charges etc., complete.
- (e) The tenderer / contractor will produce test certificate obtained from any one of the Govt. institutions for cement and steel brought to site. And only when the test results confirm to the ISI specification they will be allowed to be used in the works.
- (f) The tenderer / Contractor should strictly follow above instructions without fail.



12.	SUBMISSION OF TENDER IN TWO COVER SYSTEM						
<p>(a) Every page of the terms and conditions of the tender document should be signed and enclosed with the tender, in token of having accepted the tender conditions. Failing which the tender will be rejected summarily.</p> <p>(b) Tenders should be submitted in two parts:</p> <ol style="list-style-type: none"> i. Part I will cover technical bid and ii. Part II will cover price/financial bid <p>(c) Tenderers should ensure submission of all documents pertaining to Part-I and Part II proposals separately as per the Check list given in Annexure -X.</p> <p>(d) Tenderers are requested to place Part I and Part II documents in separate sealed covers. Part I cover to be superscripted as “Part I – Technical bid (Package No:)” and Part II cover to be superscripted as “Part II – Price bid (Package No :)” respectively, mentioning the name and address of the Tenderer in each of the both covers. These two sealed covers (Part I and Part II) must be placed in a single outer cover superscripted as “Tender for the construction of work shed buildings and amenities for Purba Bardhaman Coir Cluster, (Package No:)” and addressed to “M/s. Panuhat Karmaudyog welfare Society.,Panuhat, Boliyapara, Purba Bardhaman,713502 (W.B)” mentioning the name and address of the Tenderer in the outer cover. Tenders shall be submitted in sealed cover and unsealed tenders would summarily be rejected.</p> <p>(e) Tenders should be dropped only in the tender box kept at the office of “Coir Board Sub Regional Office New Secretariat Building C Block, Ground Floor, Kiran Sankar Roy Road, Kolkata – 700001” on or before 05.00 PM on 05.03.2021 Tenders will not be received by hand.</p> <p>(f) Alternatively, the tenders can be submitted through registered post so as to reach the above address on or before 09.00 AM on 06.03.2021. Tenders received after the specified time will not be considered and IA will not be liable or responsible for any postal delays.</p> <p>(g) A tender once submitted shall not be permitted to be altered or amended.</p>							
13.	EARNEST MONEY DEPOSIT						
<p>The Tender should be accompanied by an Earnest Money Deposit (EMD) in the form of Account Payee Demand Draft drawn on any State Bank Of India (SBI) Specialised Institutional Banking Branch, Kolkata in favor of “IA Account Panuhat Karmaudyog Welfare Society (IA) , payable at SBI Kolkata . EMD for each package is given below:</p> <table border="1" style="margin-left: auto; margin-right: auto;"> <thead> <tr> <th>S.No</th> <th>Package</th> <th>EMD (in Rs.)</th> </tr> </thead> <tbody> <tr> <td style="text-align: center;">1.</td> <td style="text-align: center;">Package I</td> <td style="text-align: center;">1,57,000</td> </tr> </tbody> </table> <p>(a) The EMD in any other form will not be accepted. The Earnest Money Deposit will be returned to the unsuccessful tenderers at the earliest on the expiry of final bid validity and latest on or before the 30th day of the award of contract. The bids received without EMD will be summarily rejected.</p> <p>(b) The Earnest Money Deposit will be retained in the case of successful tenderer and it will not earn any interest and will be dealt with, as provided in the terms and conditions of the tender.</p> <p>(c) Any request of the tenderer, under any circumstances claiming exemption from payment of EMD will be rejected and their Part II price offer will not be opened.</p>		S.No	Package	EMD (in Rs.)	1.	Package I	1,57,000
S.No	Package	EMD (in Rs.)					
1.	Package I	1,57,000					



If the tenderer emerges as the successful bidder and after subsequent issuance of letter of acceptance by the IA, failure to sign the agreement, to remit the Security Deposit or to execute the contract as per tender conditions, will result in the forfeiture of the EMD amount remitted.

14. **VALIDITY**

- (a) The rate quoted in the Tender should be valid for the acceptance by the IA for a minimum period of 90 days from the date of opening of the Tender.
- (b) The accepted rate of the successful tenderer is valid till the entire contract is fully completed. Escalation in the rates will not be entertained under any circumstances.

15. **OPENING AND EVALUATION OF THE TENDER**

- a) The tender box will be closed at **5.01 PM** as per the office clock on **05.03.2021 (Place of tender submission: Coir Board Sub Regional Office New Secretariat Building C Block, Ground Floor, Kiran Sankar Roy Road, Kolkata – 700001)** and the received tenders in the tender box will only be opened. Tenders received after specified date and time will not be accepted. The Tender will be opened by the Tender committee at **11.00AM on 06.03.2021** in the presence of the available Tenderers/ representatives of the Tenderers who choose to be present. **The venue of the Bid opening shall be at the Coir Board Sub Regional Office New Secretariat Building C Block, Ground Floor, Kiran Sankar Roy Road, Kolkata – 700001.** The Tenderers or their authorized agents are allowed to be present at the time of opening of the tenders.
- b) Tender Committee will inform the attested and unattested corrections, before the Tenderers and sign all such corrections in the presence of the Tenderers. If any of the Tenderers or agents not present then, in such cases the Committee will open the tender of the absentee Tenderer and take out the unattested corrections and communicate it to them. The absentee Tenderer should accept the corrections without any question whatsoever.
- c) If the date fixed for opening of the tender happens to be a Government holiday, the sealed tenders will be opened at 11.00 AM on the next day.
- d) The Technical bid will be evaluated by the tender committee in terms of the qualification Criteria. The committee reserves the right to disqualify any of the tender in case the Committee is not satisfied with the documents furnished.
- e) After the completion of evaluation of technical bids, the tenderers declared as qualified by the Committee, will be informed the date of opening of Price bid (Part II).

16. **PRICE OFFER**

- (a) The Price bid should be kept only in the Part II cover.
- (b) The price bid should be prepared as per Annexure-IX.
- (c) The price should be neatly and legibly written both in figures and words.
- (d) In case of discrepancy between the prices quoted in words and figures lower of the two shall be considered.
- (e) If a bidder quotes NIL charges/consideration, the bid shall be treated as unresponsive and will not be considered.
- (f) Part-II bid should not contain any commercial conditions. Variation in the commercial terms and conditions of the tender will not be accepted.



17.	EVALUATION OF THE PRICE
	<p>(a) The Tender committee will examine for complete, properly signed and error-free nature of the Price bid (Part II)</p> <p>(b) The comparison of the rates offered shall be based on the total all inclusive rates offered (i.e. sum of all inclusive rate offered for all the tendered items).</p>
18.	AWARD OF CONTRACT
	<p>(a) The Tenderer who has quoted lowest price (L1) will be issued the ‘Letter of Acceptance’ by the Implementing Agency.</p> <p>(b) In unavoidable circumstances, such as receipt of very limited bids or the proposal prices are substantially higher than the market value / updated cost estimate or available budget, the committee may decide upon resorting to Negotiation with the lowest evaluated responsive bidder. In such cases, the Tenderer who has quoted lowest price (L1) will be invited for negotiations and after finalizing the negotiated rate, Letter of Acceptance will be issued.</p>
19.	SECURITY DEPOSIT
	<p>(a) On receipt of the Letter of Acceptance from IA, the successful tenderer should remit a Security Deposit (SD) of 5% of the value of the contract in the form of Account payee Demand Draft from any State Bank Of India (SBI) Specialised Institutional Banking Branch, Kolkata or irrevocable Bank Guarantee with a validity period of one year in favour of “IA Account Panuhat Karmaudyog welfare society (IA)”, payable at State bank of India, SIB Branch, Kolkata within 10 (Ten) working days from the date of receipt of letter of acceptance. The EMD shall be adjusted with the Security Deposit.</p> <p>(b) Any other amount pending with IA will not be adjusted under any circumstances, against the Security Deposit if so requested.</p> <p>(c) If the Security Deposit amount is not paid within the time specified, the EMD remitted by the tenderer shall be forfeited, besides cancelling the communication of acceptance of the Tender.</p> <p>(b) Security Deposit amount remitted will not earn any interest.</p>
20.	AGREEMENT
	<p>The successful tenderer should execute an agreement as may be drawn up to suit the conditions on a non-judicial stamp paper of value, as prescribed in law on the date of remittance of Security Deposit and shall pay for all stamps and legal expenses incidental thereto. In the event of failure to execute the agreement, within the time prescribed, the EMD/SD amount remitted by the tenderer will be forfeited besides cancelling the Tender.</p>
21.	ISSUE OF WORK ORDER
	<p>After payment of Security Deposit and successful execution of the agreement, Work Order will be released within 10 days by the IA. The successful tenderer should complete the Construction Of Processing Centre, Office And Training Centre shed buildings and amenities within 120 days from the date of receipt of Work Order.</p>
22.	DEFECT IDENTIFICATION AND IT’S RECTIFICATIONS
	<p>(a) Defect Liability period shall be 6 months from the date of the completion of work. Any defect arising in the work in guarantee period due to faulty workmanship and faulty materials should be rectified by contractor at his own cost.</p>



- (b) Any deficiency in concreting such as cracking, excessive honeycombing, exposure of reinforcement or other fault which entail replacement of the defective part by fresh concrete and whatsoever remedy reasonable required without hampering the structural safety and architectural concept, all at the cost of contractor.
- (c) The successful tenderer should submit bank guarantee equivalent to 10% of the total value of contract valid for 6 months towards Defect Liability.

23. **EMPLOYMENT OF TECHNICAL ASSISTANTS**

- (a) The tenderer shall employ qualified technical persons at his cost to supervise the work and the tenderer should ensure the presence of the technical persons at the site of work during working hours, monitoring all items of works and paying extra attention to such works as may demand special attention.
- (b) A movement register should be opened and maintained for Technical persons employed by the Contractor. The Technical persons should note the arrival and the departure timings every day along with their initials in a register. Such Register should be produced during inspection of the Inspecting Officers (Tender committee members).

24. **PAYMENT TERMS**

- (a) **30% of the contract value** will be paid on completion of Foundation level works and submission of Stage level completion certificate by a Chartered Engineer, based on the inspection report by Tender Committee.
- (b) **40% of the contract value** will be paid on completion of roof level works and submission of Stage level completion certificate by a Chartered Engineer, based on the inspection report by Tender Committee.
- (c) **The balance 25% and SD** will be released only after satisfactory completion of the entire contract based on the inspection report by Tender Committee and submission of Chartered Engineer's work completion & valuation certificate and bank guarantee equivalent to 10% of the total value of contract valid for 6 months towards Defect Liability.
- (d) **The balance 5% and SD** will be released only after satisfactory completion of the entire contract based on the inspection report by Tender Committee and submission of Chartered Engineer's work completion & valuation certificate and bank guarantee equivalent to 10% of the total value of contract valid for 6 months towards Defect Liability.
- (e) IA also reserves the right to recover any dues from the tenderer, which is found on later date, during audit/excess payment, after final settlement is made to them. The successful tenderer is liable to pay such dues to the IA immediately on demand, without raising any dispute/protest.

25. **PENALTY**

- (a) Failure to execute the entire contract within 120 days from the date of issue of work order will attract a penalty of 1% per week, on the full value of the contract upto a maximum of 5%. Delays beyond that period will be viewed as violation of the contract terms and will be dealt accordingly.
- (b) Implementing agency reserves the right to inspect the site at any point of time during the contract period to ensure the progress and quality of work carried out. During the inspection, if any discrepancies found in the quality of work / material used, the IA, with the approval of the tender committee, reserves the right to order for any rework(s) / replace any item(s) of material, as the case may be, in order to ensure the quality of work / progress as per the contract terms.



- (c) All the materials used for construction shall be first use, new, high quality material. Old or Used materials will not be accepted and if found, the decision of Committee, either for rework / replace / deduction in payment shall be binding on the contractor.
- (d) Any delay on the part of IA should be intimated and sorted out immediately without affecting the progress of works.

26. TERMINATION OF CONTRACT

IA reserves the right to terminate the contract at any time during the validity period on account of non-fulfillment of contract or for any of the reasons.

27. GENERAL CONDITIONS

- (a) Conditional tender in any form will not be accepted.
- (b) Any notice regarding any matters, to the contractor shall deemed to be sufficiently served, if given in writing to his usual or last known place of business.
- (c) Tender committee reserves the right to relax or waive or amend any of the tender conditions.
- (d) The successful tenderer shall not outsource/off load either full or part of the work to any other agency / individual.
- (e) If the performance of the tenderer is not as per the schedule, then tender committee reserves the right to cancel / reallocate full or part of the contract, at any stage of the contract execution.

28. ARBITRATION

- (a) In case of any dispute in the tender, including interpretation, if any, on the clauses of the tender or the agreement to be executed, the matter shall be referred by IA / Tenderer to an Arbitrator to be appointed by the Parties hereto by mutual agreement. If no such Arbitrator could be appointed by mutual consent, the matter may then be referred to the Chairman, Coir Board for nominating an Arbitrator, the Arbitration proceedings being governed by the Arbitration and Conciliation (Amendment) Act 2015.
- (b) The venue of the Arbitration shall be at the Coir Board Sub Regional Office New Secretariat Building C Block, Ground Floor, Kiran Sankar Roy Road, Kolkata – 700001. The decision of the Arbitrator shall be final and binding on both the parties to the Arbitration.
- (c) The Arbitrator may with the mutual consent of the parties, extend the time for making the award. The award to be passed by the Arbitrator is enforceable in the court at KOLKATA only.

29. JURISDICTION OF THE COURT

Any dispute arising out of non-fulfillment of any of the terms and conditions of this Agreement or any other dispute arising out of the arbitration award will be subject to the jurisdiction of the Courts in the City of KOLKATA only.



We agree to the above terms and conditions.

SIGNATURE OF THE TENDERER:

DATE:

NAME IN BLOCK LETTERS:

DESIGNATION:

ADDRESS:



ANNEXURE – I

Bid :-

Part – 1 Scope of work – Civil Works only

S.No	Sections of construction
1	Industrial shed for defibring unit
2	Industrial shed for spinning unit,
3	Industrial shed for geotextile and matting
4	Office administrative building

Part-2

S.No	Sections of Item
1	Well & Pump Set

1. INDUSTRIAL SHED FOR DEFIBRING UNIT

Decription of Item	no	length (M)	Breat h (M)	Heigh t (M)	Quantit y	Total Quantit y	Unit	Rate	Amount
Earth work in excavation in foundation trenches or drains or, septic tank soak well etc in all sorts of soil (including mixed soil but excluding moorum and laterite or sand stone) including removing, spreading or stacking the spoils within a lead of 75 M as directed including trimming the side of trenches leveling dressing and ramming the bottom bailing or pumping out water etc. as required complete.Depth of excavation not exceeding 1.5 m (not required showing)									



a) Depth of excavation not exceeding 1,500 mm									
For Footings	14	1.20	1.20	1.50		30.24			
For Tie Beam (for outer wall)	1	50.16	0.38	0.38	7.24	37.483	Cum	119.27	4,470.61
(b) Depth of excavation for additional depth beyond 1,500 mm. and up to 3,000 mm. but not requiring shoring									
Filling in foundation or plinth by fine sand in layers not exceeding 150 mm as directed and consolidating same by through saturation with water ramming complete including the cost of supply of sand [payment to be made on measurement of finished quantity.]									
For Footings	14	1.20	1.20	0.15	3.02				
For Tie Beam (for outer wall)	1	50.16	0.38	0.15	2.86				
Below floor	1	14.74	11.692	0.85	146.49				
					0.00	152.372	cum	543.51	82,815.81
Earth work in filling in foundation trenches or plinth with good earth, in layers not exceeding 150 mm. including watering and ramming etc. layer by layer complete. (Payment to be made on the basis of measurement of finished quantity of work)(1/5 of Excavation)						7.497	Cum	77.54	1,148.06
Single Brick Flat Soling over fine sand joint with local sand									
Foundation Column	14	1.2	1.2		20.16				

Tie Beam	1	50.2	0.25		12.54				
						32.700	sqm	324.00	10,594.80
Ordinary Cement concrete (mix 1:2:4) with graded stone chips (20 mm nominal size) excluding shuttering and reinforcement if any, in ground floor as per relevant IS codes					0.00				
For Footings	14	1.20	1.20	0.15	3.02		Cum	5326.00	1,53,788.31
Floor	1	14.74	11.692	0.15	25.85	28.88			
Brick work with 1st class brick in cement mortar (6:1)					0.00				
In foundation & plinth up to PL	1	50.16	0.25	0.60	7.52	7.524	Cum	4882.00	36,732.17
Description of items	No	L (m)	B (m)	H (m)	Qty	Total Quantity	Unit	Rate	Amount
Hire and labour charges for shuttering with centering and necessary staging upto 4 m. using approved stout props and thick hard wood planks of approved thickness with required bracing for concrete slabs, beams, columns, lintels curved or straight including fitting, fixing and striking out after completion of works.(upto roof of ground floor)									
Side of footing	56	1.20	0	0.15	10.08				
Column ()	28	0.250		6.63	46.38				
	28	0.25		6.63	46.38				
Side of tie beam (for outer wall)	8	50.16		0.250	100.32				
						156.775	Sqm	205.00	32,138.88
Ordinary Cement concrete (mix									

1:1.5:3) with graded stone chips (20 mm nominal size) excluding shuttering and reinforcement if any, in ground floor as per relevant IS codes									
Footing = $(1.2+0.25)/2=0.725$ m									
	14	0.725	0.725	0.4	2.9435				
Column	14	0.250	0.25	6.63	5.80				
Tie beam	4	50.16	0.25	0.250	12.54				
					0.00	21.280	Cum	6012.00	127937.61 45
Description of items	No	L (m)	B (m)	H (m)	Qty	Total Quantity	Unit	Rate	Amount
Reinforcement for reinforced concrete work in the all sorts of structures including distribution bars, stirrups, binders etc. including supply of rods, initial straightening and removal of loose rust (if necessary), cutting to requisite length, hoofing and bending to correct shape, placing in proper position and binding with 16 gauge black annealed wire at every intersection, complete as per drawing and direction. In ground floor.(Other than SAIL/TATA/RINL)									
1% of the total concrete volume						1.670	M.T	60433.00	100923.11

Supplying fitting & fixing Zn-All alloy(55%Al &45%Zn)coating of 150grams per Sq meter (followed by colour coated on both side)Steel sheet work having minimum yield strength of 550MPa of trapezoidal profile of approved make (excluding the supporting frame work)fitted and fixed with 55 mm & 25mm th,washer etc.complete with 150 mm end lap and one corrugation minimum side lap (Payment to be made on area of finished work)0.50mmthicksheet	2	16.14	6.865		221.60	221.602	Sqm	896.00	198555.5712
Estimate for Truss Structure									227632

	976737.197
Electrification Charges @5%	48837
Water Supply cost@5%	48837
Total	1074411
(Provisional Tax) Add GST@ 12%(B)CGST 6% SGST 6%	128929
Add 1% Labour cess	12033
Contingency (1%)	12,033.00
TOTAL ESTIMATED COST	12,27,406.00

Rupees Twelve lakh twenty seven thousand four hundred six rupees.



SCALE = 1:100
ALL DIA IN MM

BUILDING PLAN FOR DEFIBRING SECTION OF PURBA BARDHAMAN COIR CLUSTER
 (SPV) PANUHAT RURAL WELFARE SOCIETY, MOUZA- SAHAPUR, J.L NO- 95,
 PLOT NO 1203, 1204, 1205,
 KH. NO- (1481, 1482, 1485, 1486, 1488, 1489, 1494) (1484, 1490, 1495, 1496) (1507, 1487),
 P.S-KATWA, DIST-PURBA BARDHAMAN, UNDER AGRADWIP GP

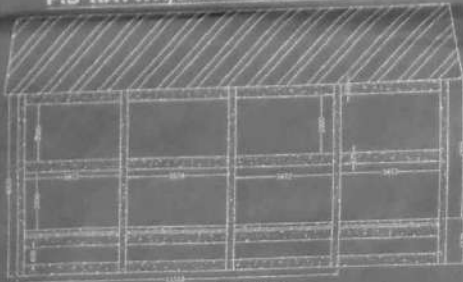

SECTION

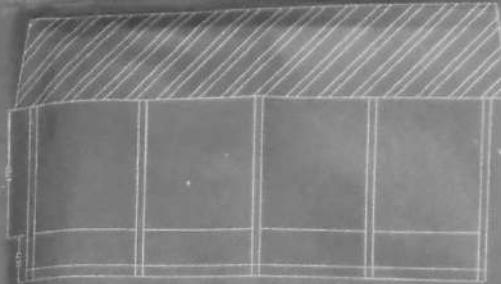

FRONT ELEVATION



DEFIBRING SECTION

PLAN

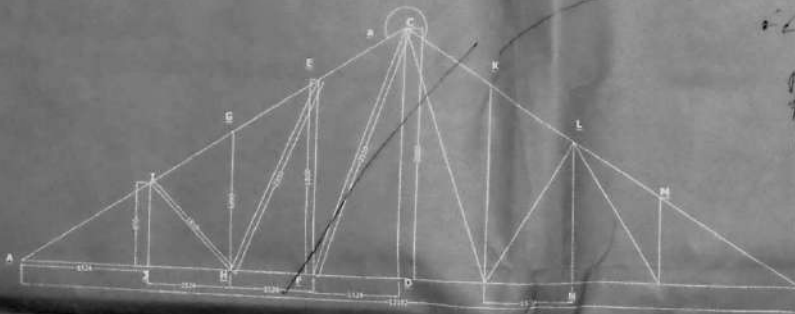
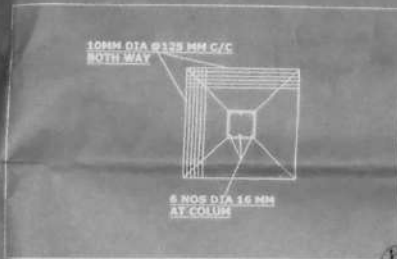

C/S OF TUBULAR TRUSS

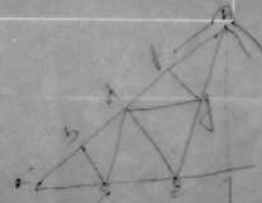

*PR-2h - 65mm-M
 THE BEAM - 2j = 50mm-M
 de, dg, de, bc - 2 5mm-M
 he - 4mm-M
 hj - 20mm-M
 bracing at c & e on both side 30mm-M*

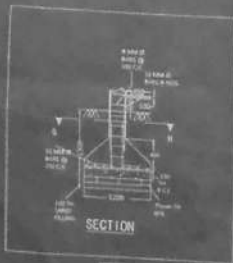

SECTION



SECTION OF G-H



Tie Beam

Lintel

SPECIFICATION

1. ALL DIMENSION ARE IN MM OTHERWISE IT MENTION.
2. RAIL WALL ARE 250 MM, 125 MM.
3. 250 MM TH BRICK WORK IN WALL WITH (1:4) CEMENT MORTAR.
4. 125 MM TH BRICK WORK IN WALL WITH (1:4) CEMENT MORTAR.
5. R.C C IN LINTEL, CHAJJA, SIAL, ROOF, STAIR (1:2:4).
6. TOP STEEL = 12 % OF CONCRETE VOLUME.
7. MARBLE FLOORING IN GROUND IN FIRST FLOOR.
8. 10 MM TH SAND & CEMENT PLASTER (1:1) AT CEILING.
9. 15 MM TH SAND & CEMENT PLASTER (1:1) AT INSIDE.
10. 15 MM TH SAND & CEMENT PLASTER (1:1) AT OUTSIDE.
11. 25 MM TH D.P.C.
12. SINGLE LAYER BRICK FLAT SOLING OVER 100 MM TH SAND FILLING.

PARTICULARS

1. TOTAL PLOT AREA = 2781 SQM
2. PROPOSED COVERED AREA = 185.8 SQM



2. **INDUSTRIAL SHED FOR SPINNING UNIT**

Decription of Item	no	length (M)	Breath (M)	Height (M)	Quantity	Total Quantity	Unit	Rate	Amount
Earth work in excavation in foundation trenches or drains or, septic tank soak well etc in all sorts of soil (including mixed soil but excluding moorum and laterite or sand stone) including removing, spreading or stacking the spoils within a lead of 75 M as directed including trimming the side of trenches leveling dressing and ramming the bottom bailing or pumping out water etc. as required complete. Depth of excavation not exceeding 1.5 m (not required showing)									
a) Depth of excavation not exceeding 1,500 mm.									
For Footings	16	1.50	1.50	1.50	54.00				
For Tie Beam (for outer wall)	1	62.00	0.25	0.25	3.88	57.875	Cum	119.27	6,902.75
(b) Depth of excavation for additional depth beyond 1,500 mm. and upto 3,000 mm. but not requiring shoring									

Filling in foundation or plinth by fine sand in layers not exceeding 150 mm as directed and consolidating same by through saturation with water ramming complete including the cost of supply of sand [payment to be made on measurement of finished quantity.]									
For Footings	16	1.50	1.50	0.15	5.40				
For Tie Beam (for outer wall)	1	62.00	0.25	0.15	2.33				
Below floor	1	18.04	14.74	0.60	159.53				
					0.00	167.253	cum	543.5 1	90,903.72
Earth work in filling in foundation trenches or plinth with good earth, in layers not exceeding 150 mm. including watering and ramming etc. layer by layer complete. (Payment to be made on the basis of measurement of finished quantity of work)(1/5 of Excavation)						11.575	Cum	77.54	1,148.06
Single Brick Flat Soling over fine sand joint with local sand									
Foundation Column	16	1.5	1.5		36.00				

Tie Beam	1	62.0	0.25		15.50				
						51.500	sqm	324.00	16,686.00
Ordinary Cement concrete (mix 1:1.5:3) with graded stone chips (20 mm nominal size) excluding shuttering and reinforcement if any, in ground floor as per relevant IS codes					0.00				
For Footings	16	1.50	1.50	0.15	5.40		Cum	6012.00	272,235.49
Floor	1				39.88				
		18.04	14.74	0.15		45.28			
Brick work with 1st class brick in cement mortar (6:1)					0.00				
In foundation & plinth up to PL	1	62.00	0.25	0.60	9.30	9.300	Cum	4882.00	45,402.60
1st class brickwork in super structure					0.00				
For Ground floor(250mm 6:1)	1	62.00	0.25	5.00	77.50				
Less for Doors									
D1	2	3.82	0.25	3.00	5.73				
W1	10	1.50	1.50	1.20	27.00				
					32.73	44.767	Cum	4812.00	215418.804

Description of items	No	L (m)	B (m)	H (m)	Qty	Total Quantity	Unit	Rate	Amount
Hire and labour charges for shuttering with centering and necessary staging upto 4 m. using approved stout props and thick hard wood planks of approved thickness with required bracing for concrete slabs, beams, columns, lintels curved or straight including fitting, fixing and striking out after completion of works. (upto roof of ground floor)									
Side of footing	64	1.50	0	0.15	14.40				
Column (G.L to P.L)	32	0.375		7.525	90.30				
	32	0.25		6.00	48.00				
Side of tie beam (for outer wall)	8	62.00		0.250	124.00				
						228.700	Sqm	203.00	46,426.10
Ordinary Cement concrete (mix 1:1.5:3) with graded stone chips (20 mm nominal size) excluding shuttering and reinforcement if any, in ground floor as per relevant IS codes									
Footing = (1.5+0.25)/2=0.875 m, Footing = (1.5+0.375)/2=0.937m,	16	0.875	0.937	0.6	7.8708	7.8708			

Column	16	0.38	0.25	8.15 0	12.39				
Tie beam	4	62.00	0.25	0.37 5	23.25				
Lintel	10	1.90	0.25	0.25	1.19				
Chajja	10	1.90	0.45	0.100 0	0.855				
						37.68			
					0.00	45.551	Cum	6012.0 0	273854.416
Description of items	No	L (m)	B (m)	H (m)	Qty	Total Quantit y	Unit	Rate	Amount
Reinforcement for reinforced concrete work in the all sorts of structures including distribution bars, stirrups, binders etc. including supply of rods, initial straightening and removal of loose rust (if necessary), cutting to requisite length, hoofing and bending to correct shape, placing in proper position and binding with 16 gauge black ennealed wire at every intersection, complete as per drawing and direction. In ground floor. (Other than SAIL/TATA/RINL)									
1% of the total concrete volume						3,575	M.T	60433 .00	216047.97 5
Wood work in door and window frame fitted and fixed in									

position complete including a protective coat of painting at the contact surface of the frame excluding cost of concrete, Iron Butt Hinges and M.S clamps. (The quantum should be corrected up to three decimals).									
h) Neem, Jam, Jackfruits									
W1	10	6.00	0.10	0.07	0.42	0.420	Cum	53057.00	22,283.94
Panel shutters of door and window, as per design (each panel consisting of single plank without joint), including fitting and fixing the same in position but excluding the cost of hinge and other fittings. In ground floor. (In case of non-supply of single plank, penal rate of reduction of 20% will be made)									
(iv) 25mm thick shutters with 12mm thick panel of size 30 to 45 cm.									
b) Sishu, Gamar, Champ, Badam, Bhola, Mogra, Hallak.									
W1	10	1.40		1.40	19.60	19.600	Sqm	2149.00	42,120.40
Description of items	No	L (m)	B (m)	H (m)	Qty	Total Quantity	Unit	Rate	Amount
Iron butt hinges of approved quality fitted and									

fixed with steel screws,with ISI mark									
100mm X 58 mm X 1.9 mm for doors &									
Iron socket bolt of approved quality fitted and fixed complete									
For Windows (150mm long x 10mm dia bolt.)	10					10.000	nos.	63.00	630.00
Iron hasp bolt approved quality fitted and fixed complete (oxidized)with 16 mm dia rod with centre bolt & round fitting (300mm long.)									
	10					10.000	nos.	166.00	1660.00
Plaster (to wall, floor, ceiling etc.) with sand and cement mortar including rounding off or chamfering corners as directed and raking out joints including throating, nosing and drip course, scaffolding/staging where necessary (Ground floor). [Excluding cost of chipping over concrete surface]									
15 mm thick inside plaster with cement mortar 1:6									
For Ground floor	1	65.56		5.50	360.56				
Less for doors & windows W1	10	1.50		1.50	22.50				
D	2	3.82		3.00	22.93	315.13	Sqm	134	42226.884
a) Supplying, fitting and fixing steel rolling shutter profile type with 18 B.G . of approved type steel	2	3.82		3.00	22.93	22.932	Sqm	2107.00	48,317.72

lathe section 75mm wide, fitted with coil wire spring to necessiate the fitting of required Nos. of C.I. Pulleys on heavy type solid drawn seamless steel tube complete with locking arrangements both inside and outside specially builtup side guide channels including providing a hood for the steel rolling shutter in the room, painting two coats of approved aluminium paint over a coat of red lead primer complete [P-106 ; Item No:- 19]									
MS or W.I Ornamental Gril of Approved design joints continuously welded MS WI flats and bars of windows rallig etc fitted and fixed with necessary secrews weight @16Kg/Sqm,page 104,SI no 13i	10	1.50	1.5		22.50	360.000	Kg	72.38	26,056.80
20 mm thick outside plaster with cement mortar 1:6									
For Ground floor	1	65.56		6.53	427.75				
Less for doors & windows W1	10	1.50		1.50	22.50				
	2	3.82		3	22.93				
						382.321	Sqm	152.00	58,112.78
Applying exterior grade acrylic primer approved make (one cote)same as Plaster area ,page 196 SI no 8					697.45	697.447	Sqm	31.40	21,899.83
Protective & decorative Acrylic emulsion paint approved make two coat page 197 SI no 17a					697.45	697.447	sqm	67.00	46728.942
Painting with superior quality aluminium paint of approved make and brand including smoothening surface by sand papering etc. on steel surface :	4	7.644		6	183.46				

Shutter	2	5.742		6	68.90				
Window	10	1.5		1.5	22.50	274.860	Sqm	57.00	15667.02
Supplying fitting & fixing Zn-All alloy(55% Al &45%Zn)coating of 150grams per Sq meter (followed by colour coated on both side)Steel sheet work having minimum yield strength of 550MPa of trapizoidal profile of approved make (excluding the supporting frame work)fittedand fixed with 55 mm & 25mm th,washer etc.complete with 150 mm end lap and one corrugation minimum side lap (Payment to be made on area of finished work)i)0.50mmthicksheet	2	19.438	8.45		328.502 2	328.502	Sqm	896.00	294337.971

Estimate for Stress Structure	224771
TOTAL Cost Rs.	2029838.974
Electrification Charges @5 %	101492
Water Supply cost@5%	101492
TOTAL	2232823
(Provisional Tax) Add Gst@12%(B) CGST 6% SGST 6%	267939
Total	2500762
Add 1% Labour cess	25008
Contingency 1%	25008
Total Estimate Cost	25,50,777

Rupees twenty Five Lacks seven hundred and seventy seven only..



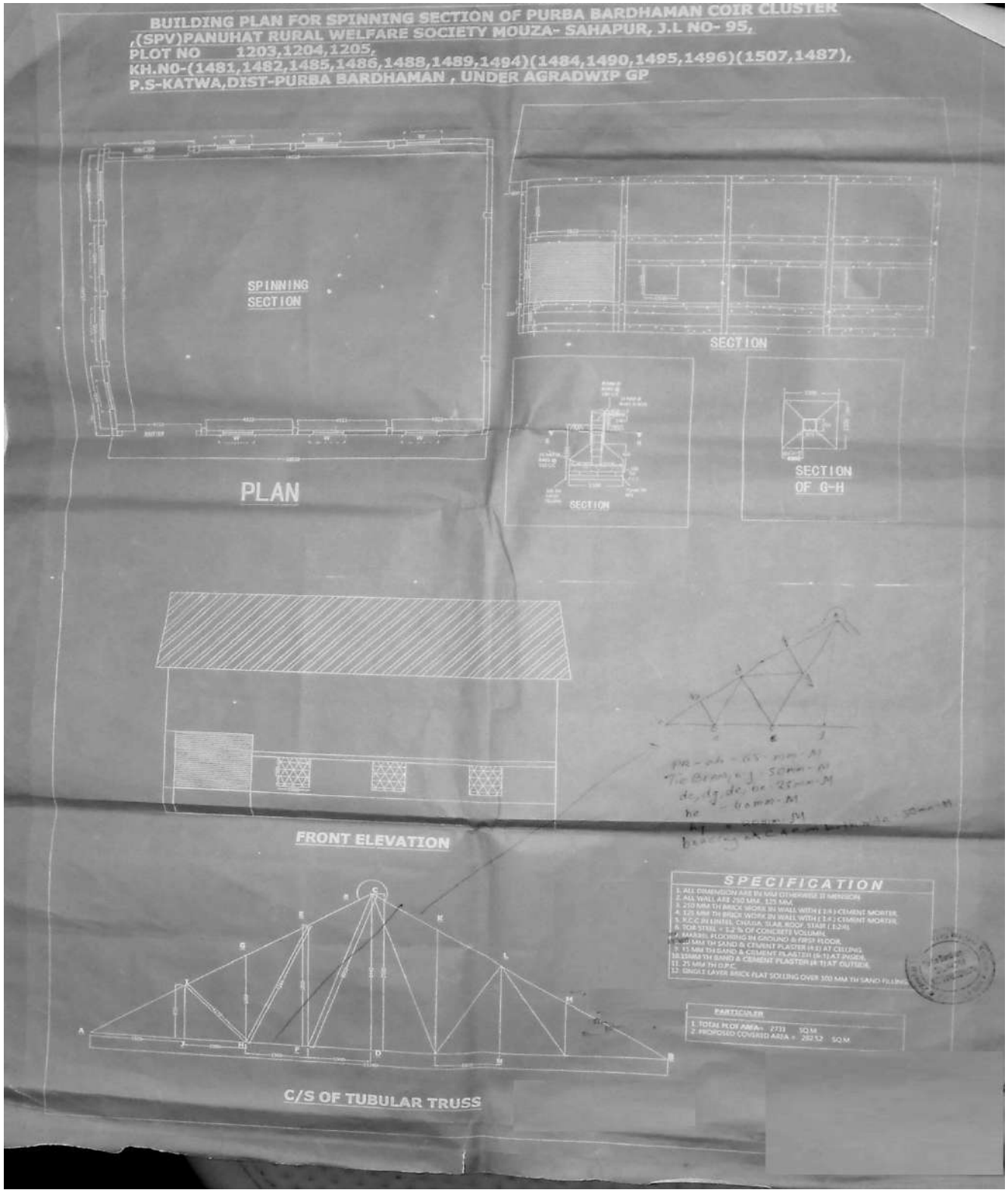

3. GEO-TEXTILE, MATTING SECTION AND STORE ROOM

Description of items	No	L (m)	B (m)	H (m)	Qty	Total Quantity	Unit	Rate	Amount (Rs.)
Earth work in excavation in foundation trenches or drains or, septic tank soak well etc in all sorts of soil (including mixed soil but excluding moorum and laterite or sand stone) including removing, spreading or stacking the spoils within a lead of 75 M as directed including trimming the side of trenches leveling dressing and ramming the bottom bailing or pumping out water etc. as required complete.Depth of excavation not exceeding 1.5 m (not required showing)									
a) Depth of excavation not exceeding 1,500 mm.									
For Footings	26	1.50	1.50	1.50	87.75				
Septic tank	1	2.50	2.10	1.80	9.45				
For Tie Beam (for outer wall)	1	98.52	0.25	0.25	6.16	103.358	Cum	119.27	12,327.48
(b) Depth of excavation for additional depth beyond 1,500 mm. and upto 3,000 mm. but not requiring shoring Filling in foundation or plinth by fine sand in layers not exceeding 150 mm as directed an consolidating same by through saturation with water ramming complete including the cost of supply of sand [payment to be made on measurement of finished quantity.]									
For Footings	26	1.50	1.50	0.15	8.78				
Septic tank	1	2.50	2.10	0.10	0.53				
For Tie Beam (for outer wall)	1	98.52	0.25	0.15	3.69				
Below floor	1	22.41	14.74	0.80	264.22				

					0.00	277.218	cum	543.51	150,670.75
Earth work in filling in foundation trenches or plinth with good earth, in layers not exceeding 150 mm. including watering and ramming etc. layer by layer complete. (Payment to be made on the basis of measurement of finished quantity of work)(1/5 of Excavation)						20.672	Cum	77.54	1,148.06
Single Brick Flat Soling over fine sand joint with local sand									
Foundation Column	26	1.5	1.5		58.50				
Tie Beam	1	98.5	0.25		24.63				
Septic tank	1	2.50	2.10		5.25				
						88.381	sqm	324.00	28,635.44
Ordinary Cement concrete (mix 1:2:4) with graded stone chips (20 mm nominal size) excluding shuttering and reinforcement if any, in ground floor as per relevant IS codes					0.00				
For Footings	26	1.50	1.50	0.15	8.78				
Floor	1	13.51	14.74	0.15	29.88				
Septic tank	1	2.50	2.10	0.15	0.79				
Floor	1	8.89	14.74	0.15	19.66	59.10	Cum	6012.00	3,55,335.51
Brick work with 1st class brick in cement mortar (6:1)					0.00				
Side wall at Septic tank	2	2.5	0.25	1.8	2.25				
	2	2.1	0.25	1.8	1.89				
In foundation & plinth up to PL	1	98.52	0.25	0.60	14.78	18.919	Cum	4882.00	92,360.61

1st class brickwork in super structure					0.00				
For Ground floor(250mm 6:1)	1	77.23	0.25	5.00	96.54				
Less for Doors									
Shutter	2	3.82	0.25	3.00	5.73				
W1	10	1.50	1.50	1.20	27.00				
Shutter	2	2.87	0.25	3.00	4.31	37.040	Cu m	4812.00	178234.07 4
125 mm thick brick work with sand cement mortar (1:4)									
Septic tank	1	2.10	1.20		2.52				
Toilet	1	12.50	3.00		37.49				
						40.008	Sqm	660.00	26405.28
Description of items	No	L (m)	B (m)	H (m)	Qty	Total Quantity	Unit	Rate	Amount
Hire and labour charges for shuttering with centering and necessary staging upto 4 m. using approved stout props and thick hard wood planks of approved thickness with required bracing for concrete slabs, beams, columns, lintels curved or straight including fitting, fixing and striking out after completion of works.(upto roof of ground floor)									
Side of footing	104	1.50	0	0.15	23.40				
Column (G.L to P.L)	52	0.375		7.525	146.74				
	52	0.25		6.00	78.00				
Side of tie beam (for outer wall)	8	98.52		0.250	197.05				
Septic tank slab	1	2.50	2.1		5.25				
Toilet Slab	1	3.65	3.56		12.99				
						372.436	Sqm	205.00	76,349.28
Ordinary Cement concrete (mix 1:1.5:3) with graded stone chips (20 mm nominal size) excluding shuttering and reinforcement if any, in ground floor as per relevant IS codes									
Footing $= (1.5+0.25)/2=0.875$ m, Footing $= (1.5+0.375)/2=0.937$ m,									
	26	0.875	0.937	0.4	8.5267	8.5267			
Column	21	0.38	0.25	8.150	16.26				

	5	0.38	0.25	5.050	2.40				
Tie beam	4	98.52	0.25	0.250	24.63				
Lintel	6	1.90	0.25	0.25	0.71				
Chajja	6	1.90	0.45	0.1000	0.513				
Septic tank slab	1	2.50	2.10	0.1000	0.525				
Toilet Slab	1	3.65	3.56	0.10	1.30	46.34			
					0.00	54.866	Cu m	6012.00	329851.98 7
Description of items	No	L (m)	B (m)	H (m)	Qty	Total Quantit y	Uni t	Rate	Amount
Reinforcement for reinforced concrete work in the all sorts of structures including distribution bars, stirrups, binders etc. including supply of rods, initial straightening and removal of loose rust (if necessary), cutting to requisite length, hoofing and bending to correct shape, placing in proper position and binding with 16 gauge black annealed wire at every intersection, complete as per drawing and direction. In ground floor.(Other than SAIL/ TATA/RINL)									
@ 1% of the total concrete volume						4.306	M.T	60433.00	260224.49 8
Wood work in door and window frame fitted and fixed in position complete including a protective coat of painting at the contact surface of the frame excluding cost of concrete, Iron Butt Hinges and M.S clamps. (The quantum should be corrected up to three decimals).									
h) Neem, Jam, Jackfruits									
W1	6	6.00	0.10	0.07	0.25	0.252	Cu m	53057.00	13,370.36
Panel shutters of door and window, as per design (each panel consisting of single plank without joint), including fitting and fixing the same in position but excluding the cost of hinge and other fittings. In ground floor. (In case of non-supply of single plank, penal rate of reduction of 20% will be made)									
(iv) 25mm thick shutters with									

12mm thick panel									
b) Sishu, Gamar, Champ,Badam,Bhola, Mogra, Hallak.									
W1	6	1.40		1.40	11.76	11.760	Sqm	2149.00	25,272.24
Description of items	No	L (m)	B (m)	H (m)	Qty	Total Quantit y	Uni t	Rate	Amount
Iron butt hinges of approved quality fitted and fixed with steel screws,with ISI mark									
100mm X 58 mm X 1.9 mm for doors &									
Iron socket bolt of approved quality fitted and fixed complete									
For Windows (150mm long x 10mm dia bolt.)	6					10.000	nos.	63.00	630.00
Iron hasp bolt approved quality fitted and fixed complete (oxidized)with 16 mm dia rod with centre bolt & round fitting (300mm long.)	6					10.000	nos.	166.00	1660.00
Plaster (to wall, floor, ceiling etc.) with sand and cement mortar including rounding off or chamfering corners as directed and raking out joints including throating, nosing and drip course, scaffolding/staging where necessary (Ground floor).[Excluding cost of chipping over concrete surface]									
15 mm thick inside plaster with cement mortar									
For Ground floor	1	96.47		5.50	530.61				
Less for doors & windows W1	6	1.50		1.50	13.50				
Shutter	2	3.82		3.00	22.93				
Shutter	2	2.87		3.00	17.23	476.95	Sqm	134	63911.166
Septic tank	1	7.40		1.80	13.32				
Toilet	1	19.49		3.00	58.48				
Supplying, fitting and fixing steel rolling shutter profile type with 18 B.G . of approved type steel latches section 75mm wide, fitted with coil wire spring to necessitate the	2	3.82		3.00	22.93				

fitting of required Nos. of C.I. Pulleys on heavy type solid drawn seamless steel tube complete with locking arrangements both inside and outside specially built-up side guide channels including providing a hood for the steel rolling shutter in the room, painting two coats of approved aluminium paint over a coat of red lead primer complete										
	2	2.87		3.00	17.23	40.158	Sqm	2107.00		84,612.91
MS or W.I Ornamental Grill of Approved design joints continuously welded MS WI flats and bars of windows ralling etc fitted and fixed with necessary secrows weight @16Kg/Sqm, page 104,SI no 13i	6	1.50	1.5		13.50	216.000	Kg	72.38		15,634.08
20 mm thick outside plaster with cement mortar 1:6										
For Ground floor	1	69.49		6.53	453.45					
Less for doors & windows W1	6	1.50		1.50	13.50					
	2	3.82		3	22.93					
	2	2.87		3	17.23					
Toilet	1	8.94		3	26.81					
						426.598	Sqm	152.00		64,842.95
Applying exterior grade acrylic primer approved make (one cote)					426.60	426.598	Sqm	31.40		13,395.19
Protective & decorative Acrylic emulsion paint approved make two coat					426.60	426.598	sqm	67.00		28582.0895
Painting with superior quality aluminium paint of approved make and brand including smoothening surface by sand papering etc. on steel surface :										
Shutter Both side	4	3.82		3	45.86					
Shutter Both side	4	2.87		3	34.45					

Window	12	1.5		1.5	27.00	107.316	Sqm	57.00		6117.012
Supplying fitting & fixing Zn-All alloy(55% Al &45% Zn)coating of 150grams per Sq meter (followed by colour coated on both side)Steel sheet work having minimum yield strength of 550MPa of trapizoidal profile of approved make (excluding the supporting frame work)fittedand fixed with 55 mm & 25mm th,washer etc.complete with 150 mm end lap and one corrugation minimum side lap (Payment to be made on area of finished work)i)0.50mmthicksheet	2	20.4	8.45		344.76					
Rest Room	1	11.18	3.9		43.602	388.362	Sqm	896.00	896.00	347972.35 2
Estimate for Truss Structure										302872
								Total Cost Rs.		2480415.7 31
										Electrification Charges @5 %
										124021
										Water Supply cost@5%
										124021
										Total
										2728457
										(Provisional tax)ADD GST@12%(B)CGST6% SGST 6%
										327415
										Total
										3055872
										Add 1% Labour cess
										30559
										Contingency 1%
										30559
										TOTAL ESTIMATED COST
										31,16,990

Rupees thirty one lakhs sixteen thousand nine hundred and ninety only



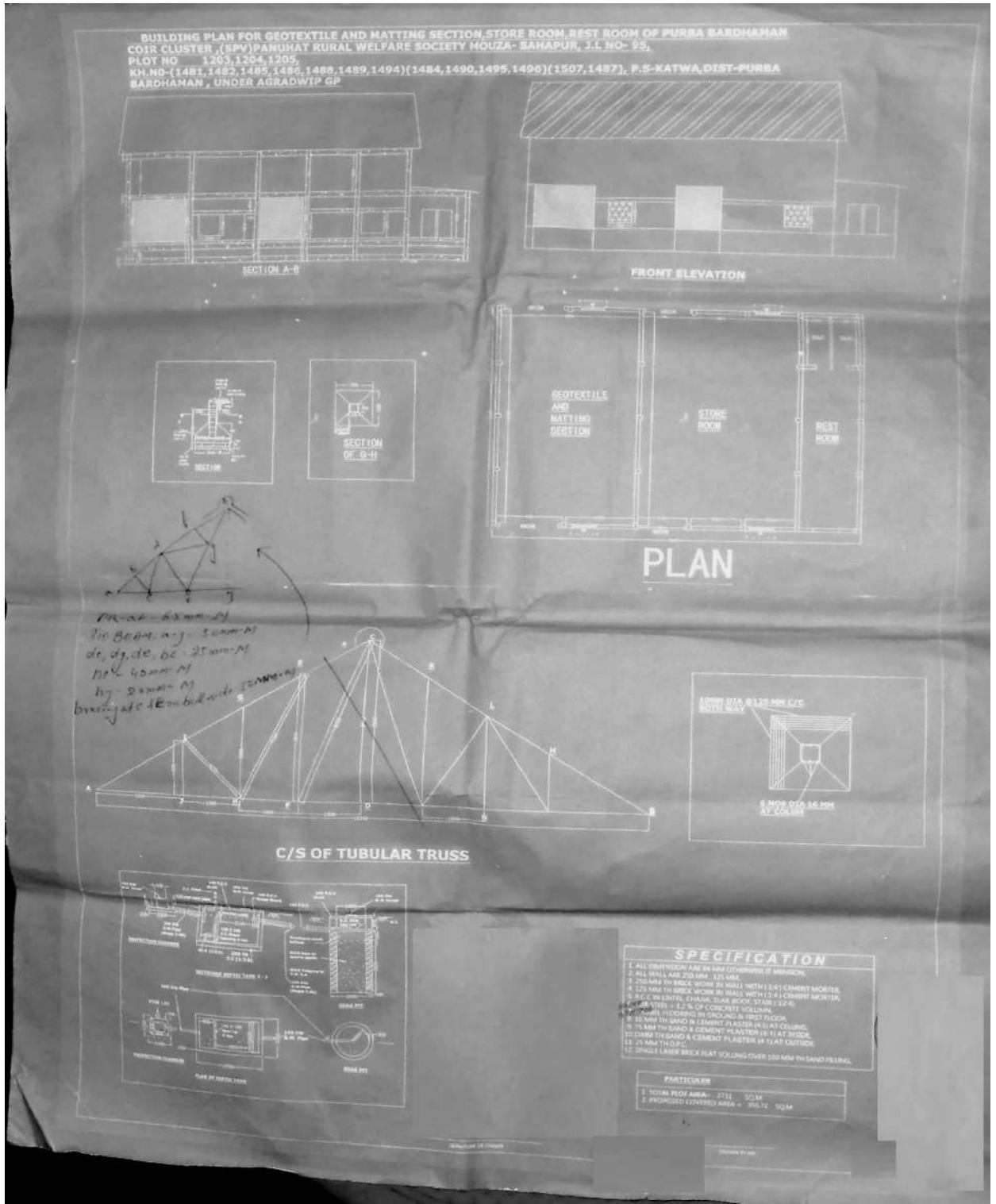

4. Administrative Building

Decription of Item	no	length (M)	Breath (M)	Height (M)	Quantity	Unit	Rate Rs.	Amount Rs
Earth work in excavation in foundation trenches or Drain ,in all sorts of soil.....as Required complete (a) Depth of Excavation not Exceeding 1.50m	12	0.9	0.9	0.9	8.748			
Septic tank	1	2.5	2.1	1.8	9.45			
					18.198	Cum	119.27	2170.48
Single layer brick flat soling of pickedjhama bricks including ramming and dressing bed to proper level ... local sand	12	0.9	0.9		9.72			
Septic tank	1	2.5	2.1		5.25			
					14.97	Sqm	324	4850.28
Filling in foundation or plinth by silver sand in layer not exceeding 150mm as directed and consolidating the samecost of supply of sand	12	1.2	1.2	0.1	1.728			
Septic tank	1	2.5	2.1	0.1	0.525			
					2.253	Cum	543.51	1224.53
Ordinary Cement concrete (mix 1:2:4) with graded Stone chips (20mm nominal size)excluding shuttering and reinforcement if any in ground floor as per relevant IS Codes. Pakur Variety	12	0.9	0.9	0.1	0.972			
Septic tank	1	2.5	2.1	0.15	0.7875			
					1.7595	Cum	4936.01	8684.91
Ordinary Cement concrete (mix 1:1.5:3) with graded Stone chips (20mm nominal size)excluding shuttering and reinforcement if any in ground floor as per relevant IS Codes.								
Column	12	0.9	0.9	0.15	1.458			
Column houch	12	0.575	0.575	0.4	1.587			
Upto G.L	12	0.25	0.25	0.2	0.15			

G.L to P.L	12	0.25	0.25	0.6	0.45			
P.L to Roof Level	12	0.25	0.25	3	2.25			
Tie Beam	4	3	0.25	0.25	0.75			
	4	2.875	0.25	0.25	0.7188			
	6	3.6	0.25	0.25	1.35			
	3	1.8	0.25	0.25	0.3375			
Lintel	1	30.74	0.25	0.15	1.1528			
Roof Slab	1	9.5	6.375	0.125	7.5703			
Wall Beam	4	3	0.25	0.25	0.75			
	4	2.875	0.25	0.25	0.7188			
	6	3.6	0.25	0.25	1.35			
	3	1.8	0.25	0.25	0.3375			
Septic tank slab	1	2.5	2.1	0.1	0.525			
Stair Waist slab 1	1	2.1	0.9	0.1	0.189			
Mid Landing	1	1.8	0.9	0.1	0.162			
Mid Landing Beam	1	1.8	0.25	0.3	0.135			
Stair Waist slab 2	1	2.1	0.9	0.1	0.189			
Step	18	0.9	0.038	0.5	0.3078			
					22.438	Cum	6012	134899.44
Hire and Labour charges for shuttering with Centering and necessary staging up to 4.00m using approved stout ...after completion of work (utto Roof of Ground floor) COL.								
Column	12	4.8	0.25		14.4			
Upto G.L	12	1	0.4		4.8			
G.L to P.L	12	1	0.4		7.2			
P.L to Roof Level	16	1	3		48			
Roof Slab	1	9.5	6.375		60.563			
Wall Beam	4	3	0.75		9			
	4	2.875	0.75		8.625			
	6	3.6	0.75		16.2			
	3	1.8	0.75		4.05			
Septic tank slab	1	2.5	2.1		5.25			
Stair Waist slab 1	1	2.1	0.9		1.89			
Mid Landing	1	1.8	0.9		1.62			
Mid Landing Beam	1	1.8	0.85		1.53			

Stair Waist slab 2	1	2.1	0.9		1.89			
Step	18	0.9	0.5		8.1			
					193.12	m2	328	63342.54
Reinforcement for reinforced concrete work in all all sort of structures including distribution bars Stirrups ,binder.....complete as per drawing and direction i) for works in foundation ,basement and upto roof of Ground floor /upto 4.00m , Toor Steel /Mild Steel								
Toor Steel /Mild Steel =1.00% of Concrete of Volume 26.14 m3	1.20/100*7850*22.44m3/1000				2.41	MT	60433	127513.6
Brick work with 1st. Class bricks in cement mortar (1:6)								
Side Wall at septic tank	2	2.5	0.250	1.800	2.25	m3		
	2	2.1	0.250	1.800	1.89	m3		
Superstructure	4	3.6	0.25	2.875	10.35	m3		
	2	1.8	0.25	2.875	2.5875	M3		
	1	5.875	0.25	2.875	4.2227	M3		
Stair Room	1	2.3	0.25	2.1	1.2075			
Deduction for								
Deduction for Window	-5	1.2	0.25	1.2	-1.8	m3		
Door (stair room)	-1	1.8	0.75	0.25	-0.338	m3		
					20.37	m3	4812	98021.19
125 mm thick brickwork with sand cement mortar(1:4)								
Room	3	3	2.875		25.875			
	2	3.6	2.875		20.7			
	2	2.875	2.875		16.531			
Toilet	2	2.1	2.85		11.97	Sqm		
Partition at Septic tank	1	2.1	1.2		2.52	Sqm		
Stair Room	1	8.3	2.1		17.43			
Less Door	-3	0.9	1.8		-4.86			
D1	-2	0.75	1.8		-2.7			
C.G	-1	1.2	1.8		-2.16			
Window	-5	1.2	1.2		-7.2			
				Total	78.106	Sqm	660	51550.13

Wood work in Door and Window frame Fitted and Fixed complete including ... of the frame excluding cost of the concrete iron but hinges and M.S Clams								
local wood								
Door frame	6	4.35	0.1	0.1	0.261			
Windows frame	6	4.4	0.1	0.1	0.264			
					0.525	m3	36302	19058.55
Z-Batten shutters of Door and Windows as per Design having tongued and groove half lap Joinedfittings in Ground floor								
a)Shutter with 25mm thick planks 19mm th. Battens b) Gamar /Sishu etc.					18.9	m2	1739	32867.10
Supplying fitting, fixing M.S Clamps for Door and Windows frame made of flate bent baras per Direction.								
(a)40mmx6mmx250mm Length					40	no	33	1320.00
Plaster (to wall, floor, ceiling etc.) with sand and cement mortar including rounding off or chamfering corners as directed and raking out joints including throating, nosing and drip course, scaffolding/staging where necessary (Ground floor).[Excluding cost of chipping over concrete surface]								
(ii) With 1:4 cement mortar								
(b) 20mm th. Plaster In side Wall					251.22	m2	172	43209.84
© 15 mm th. Plaster out side Wall					0	m2	150	0.00
(d)10mm th. Celing plaster(4:1)	1	9.625	9.423		90.696	m2	122	11064.96
Artificial stone in floor ,Dado,staircase etc. With cement concrete (4:2:1) with								

stone chips laid in panelsetc. Ground floor								
ii)25mm th. Concrete								
	2	3.6	3		21.6			
	1	7.325	2.875		21.059			
	1	5.875	1.8		10.575			
					53.234	M2	263	14000.64
(a) M.S.or W.I. Ornamental grill of approved design joints continuously welded with M.S, W.I. Flats and bars of windows, railing etc. fitted and fixed with necessary screws and lugs in ground floor. (ii) Grill weighing above 16 Kg./sq.mtr and above					1.38	Qntl.	7046	9723.48
Neat Cement Punning about 1.50mm th. In wall dado windows sills					18.14	m2	38	689.32
White washing including cleaning and smothering surface thoroughly (5parts of stone lime and 1 part of shell lime should be used in the finishing coat) of all floor								
Two Coat					341.92	%m2	1887	6451.96
Colour washing with ELLA ,with a coat of White washing including cleaning and smothering of surface								
Two Coat					341.92	%m2	2157	7375.14
Priming one coat on timber or plaster surface with Synthatic Oil Bound Primer ...etc								
One Coat					47.25	m2	41	1937.25
Extra Charge for Lump sum item								9000.00
				Total			Rs	648955.00

ELECTRIFICATION CHARGES @5%									32447.75	
WATER SUPPLY COST@5%									32447.75	
					TOTAL			RS	713850.50	
Add. 6 % C. G.S.T (PROVISIONAL TAX)	1								42831.03	
Add. 6 % S. G.S.T (PROVISIONAL TAX)	1								42831.03	
									799512.56	
Add 1% Labour CESS									7995.13	
	Total							Say	Rs	8,07,507.60
	Rs. 6,56,027.00									

Rupees EIGHT Lakhs SEVEN Thousand FIVE Hundred SEVEN Only



Part-2**Specification of Well & Pump set**

Mini Submarshal (3 inch)	Mini Sub marshal (4 inch)
I. Pipe -3inch-100ft (BONSAL UTKARSH)	i. Pipe -4inch-100ft (BONSAL UTKARSH)
II. Pipe -1.5inch-80ft (BONSAL UTKARSH)	ii. Pipe -2inch-80ft (BONSAL UTKARSH)
III. Pipe-20ft – Filter (BONSAL UTKARSH)	iii. Pipe-2inch-20ft – Filter (BONSAL UTKARSH)
IV. Motor –CRI Pump – 1HP (16Set) With Panel Box	iv. Motor –CRI Pump – 2HP (16Set) With Panel Box
V. 1.25 Column Pipe 70feet (BONSAL UTKARSH)	v. 1.50 Column Pipe 70feet (BONSAL UTKARSH)
VI. 3inch-1.5 R-S -1pcs	vi. 4inch x 2inch
VII. 1.5 s. Nipple- 1pcs	vii. 2 X 6 S.Nipple 1pcs
VIII. 1.5 Cuter -1pcs	viii. 2inch Cuter 1pcs
IX. 1.25 Adapter- 1pcs	ix. 4inch Oil Cap
X. 3inch Oil Cap – 1pcs	x. 1.50- Elbow
XI. 1.25-1G-I Elbow	xi. 1.5inch-1Feet
XII. 1inch-1Feet	xii. 2.5 Cable – 120feet (Finollex)
XIII. 1.5 Cable 120feet (Finollex)	



ANNEXURE – II**PART-I**

Date: _____

From,

Name:
Address:
Ph:
Fax:
E-mail:

To,

The Secretary/President,
Panuhat Karmaudyog Welfare Society,
Panuhat, Katwa, Purba Bardhaman, 713502 (W.B)

Sir,

Sub: Tender for the supply, erection and commissioning of machineries, equipments and its accessories for the Common Facility Center of Purba Bardhaman Coir Cluster on turnkey basis (Package Number:) - Submission of PartI- Reg

Ref: Your Tender Notice **SFURTI/PKWS/SRT-TEN/2021/01**

.....

With reference to your tender notice, we submit herewith our sealed Tender for construction of processing centre, office and training centre for M/s. Purba Bardhaman Coir Cluster, as specified by IA in this tender document.

.....

We enclose the following documents:

- 1) Tender conditions duly signed in each page and enclosed in token of accepting the Tender conditions
- 2) Demand Draft no. _____ For Rs.1, 57,000 /- (Rupees One Lakh Fifty Seven Thousand only), in favor of **IA Account Panuhat Karmaudyog Welfare Society (IA)**”, Drawn on Bank payable at SBI, SIB Branch, Kolkata towards Earnest Money Deposit.
- 3) Authorization letter from the Company for the person to sign the tender.
- 4) Details of the Tenderer (as per Annexure-III)
- 5) Average annual turnover statement duly certified by a Chartered Accountant (as per Annexure-IV).
- 6) List of Building construction works executed in last 3 years as per Annexure-V
- 7) Declaration for not having black listed by any other Govt. agencies (as per Annexure-VI).
- 8) Declaration for not having tampered the Tender documents downloaded from the websites **www.coirboard.gov.in** (Annexure-VII).



- 9) The copy of certificate of incorporation/registration (If applicable)
- 10) Copy of Registered Partnership deed, in case of Partnership Firm (If applicable)
- 11) Copy of Udyog Aadhaar, GST Registration Certificate & PAN Card
- 12) Credentials of a similar nature of work of the minimum value of 40% of the estimated amount put to tender during 5 (five) years prior to the date of issue of this tender notice
- 13) The Annual Report / certified copies of Balance Sheet, Profit & Loss statement along with schedules for the last 4 consecutive financial years FY 2016-17, 2017-18 , 2018-19 and 2019-20
- 14) Latest I.T return.
- 15) Notarized translated English version of the documents in a language other than English/ Bengali, if any.

Yours faithfully,

SIGNATURE OF THE TENDERER

Encl: As stated above



ANNEXURE - III

DETAILS OF THE TENDERER

1. Name of the Tenderer	
2. Registered Office Address	Telephone Number: Fax : Email : Website, if any
3. Contact Person	Name: Designation: Phone: Mobile: Email:
4. Date of Incorporation	
5. Legal Status	Proprietorship/partnership/Pvt. Limited/Public Limited/ others(Pl. mention)
6. Eligible license holder of	
7. Brief profile of the tenderer	
8. Number of staffs on regular payroll	Technical: Administration:
9. PAN Number	
10. GST Registration Number	

SIGNATURE OF THE TENDERER
(with seal and address)



ANNEXURE -IV**ANNUAL TURN OVER STATEMENT**

The Annual turnover of M/s for the past three years are given below and certified that the statement is true and correct.

S.no	Year	Turnover (Rs. in lakh)
1	2016-2017	
2	2017-2018	
3	2018-2019	
4	2019-2020	
	Total	
Average annual turnover (for latest 3 years)		

DATE :

SIGNATURE OF THE TENDERER

SIGNATURE OF CHARTERED ACCOUNTANT
(with seal and Address)



ANNEXURE - V**LIST OF CLIENTS FOR WHOM CIVIL CONSTRUCTION WORKS UNDERTAKEN IN THE
PAST 3 YEARS**

(Please provide the details for each project in separate sheet along with work Order/completion certificate from client)

S.No	Name & Address of the Client	Details of Work	Extent/Area covered in Sq.ft	Year of Completion	Cost (Rs.in Lakhs)	Work Order & Completion certificate enclosed (Yes/No)
1.						
2.						
3.						
4.						
5.						
6.						
7.						
8.						
9.						
10.						

SIGNATURE OF THE TENDERER
(with seal and address)



ANNEXURE - VI

CERTIFICATE

Date: _____

Certified that M/s...../ the firm /company or its partners / share holders had not been blacklisted by any Government Agencies.

SIGNATURE OF THE TENDERER
(with seal and address)



ANNEXURE - VII**DECLARATION FORM**

Date: _____

a) I/We.....having our office at do declare that I/We have carefully read all the conditions of tender floated vide tender ref.no._____ for the construction of processing centre, office and training centre for M/s. Purba Bardhaman Coir Cluster and will complete the contract as per the tender conditions.

b) I/We have downloaded the tender document from the internet site **www.coirboard.gov.in** and I/We have not tampered / modified the tender document in any manner. In case, if the same is found to be tampered / modified, I/ We understand that my/our tender will be summarily rejected and full Earnest Money Deposit will be forfeited and I/We am/are liable to be banned from doing business with M/s. Panuhat Karmaudyog Welfare Society or prosecuted.

SIGNATURE OF THE TENDERER
(with seal and address)



ANNEXURE - VIII

PART-II

From,

Name:
Address:
Ph:
Fax:
E-mail:

To,

The Secretary/President

M/s .Panuhat Karmaudyog Welfare Society

Panuhat, Katwa, Purba Bardhaman 713502

West Bengal

Sir,

Sub: Tender for the construction of construction of processing centre, office and training centre for Purba Bardhaman Coir Cluster (Package Number: _____) - Submission of Part II - Price Offer-Reg.

Ref:- Our tender (Technical Bid) submitted for the “construction of processing centre, office and training centre for M/s. Purba Bardhaman Coir Cluster”

In continuation of our above tender, we submit herewith the price offer for the “construction of processing centre, office and training centre Purba Bardhaman Coir Cluster” as specified by IA in this tender document.

We agree to abide by the terms and conditions stipulated by the IA and also agree to complete the entire contract, at the rates quoted by us. The rate quoted and approved by the IA in this tender will hold good as per IA tender conditions.

Yours faithfully,

SIGNATURE OF THE TENDERER



ANNEXURE - IX

PRICE BID

(Amount in Rs.)

Description	Basic Amount	SGST	CGST	IGST	Total Price including taxes
Construction of processing centre, office and training centre for the Common Facility Centre I of Purba Bardhaman Coir Cluster as per drawing and BoQ of Package I given in Annexure I					
Grand Total					

Amount in Words: Rupees _____ only

Note:

- a) The Bidder shall quote the Lump sum costs in the above given format.
- b) The lump sum offer shall provide for all superintendence, labour, technical assistance, material, plant, equipment and all other things required for executing and completing all the works as per defined Scope of Work.

SIGNATURE OF THE TENDERER
(with seal and address)



ANNEXURE - X

CHECKLIST OF DOCUMENTS**Documents to be enclosed in Part-I:**

S.No	Checklist	Enclosed (Yes/No)	Reference in the Bid (Page No.)
1.	A covering letter on your letter head addressed to the Secretary/President, Panuhat Karmaudyog Welfare Society, Panuhat,Katwa,Purba Bardhaman,713130 (W.B) (as per Annexure-II)		
2.	Tender conditions duly signed in each page and enclosed in token of accepting the Tender conditions		
3.	Demand Draft No.....for Rs.1,57,000/- (Rupees One Lakh Fifty Seven Thousand only), in favour of “IA ACCOUNT PANUHAT KARMAUDYOG WELFARE SOCIETY (IA) ” , payable towards Earnest Money Deposit.		
4.	Authorization letter from the Company for the person to sign the tender		
5.	Details of the Tenderer (as per Annexure-III)		
6.	Average annual turnover statement duly certified by a Chartered Accountant (as per Annexure-IV)		
7.	List of Building construction works executed in last 3 years as per (Annexure-V)		
8.	Declaration for not having black listed by any other Govt. agencies (as per Annexure-VI)		
9.	Declaration for not having tampered the Tender documents downloaded from the websites www.coirboard.gov.in (Annexure-VII).		
10.	The copy of certificate of incorporation/registration.		
11.	Copy of Registered Partnership deed, in case of Partnership Firm		
12.	Copy of Udyog Aadhaar, GST Registration Certificate & PAN Card		
13.	Credentials of a similar nature of work of the minimum value of 40% of the estimated amount put to tender during 5 (five) years prior to the date of issue of this tender notice.		
14.	Work Orders issued by the clients		
15.	Performance certificate issued by the clients		
16.	The Annual Report / certified copies of Balance Sheet, Profit & Loss statement along with schedules for the last 3 consecutive financial years FY 2016-17, 2017-18 and 2018-19 (OR) 2017-18, 2018-19 and 2019-20.		
17.	Latest I.T return		
18.	Notarized translated English version of the documents in a language other than English/Bengali, if any		



Documents to be enclosed in Part-II

S.No	Checklist	Enclosed (Yes/No)
1.	A covering letter on your letter head addressed to the Managing Director, M/s.Panuhat Karmaudyog Welfare Society, Panuhat, Katwa, Purba Bardhaman, 713502 (W.B) (as per Annexure-VIII)	
2.	Price Bid as per Annexure- IX of the Tender document.	

Both ‘Part I – Technical bid’ cover and ‘Part II – Price bid’ cover must be placed in a separate sealed cover superscripted as “Tender for the construction of processing centre, office and training centre for Purba Bardhaman Coir Cluster (Package No:)” and addressed to “M/s.Panuhat Karmaudyog Welfare Society., Panuhat, Katwa, Purba Bardhaman, 713502 (W.B)”, containing the name and address of the Tenderer.

Note: Tenders submitted in unsealed cover would summarily be rejected.

